

OFF GRID SOLAR INVERTOR

Sm-3kw Series



3KW | Dual output

Sm-3kw is a multi-function inverter/charger, combining functions of inverter, MPPT solar charger and battery charger to offer uninterrupted power support in portable size. Sm-3kw Series can run without battery. The Maximum PV input voltage can reach 400V, which can help customers make full use of solar energy.

- Pure sine wave output
- Smart LCD setting (Working modes, Charge Current, Charge Voltage, etc)
- Built-in MPPT solar charge controller
- Wide PV input voltage range
- Can provide the power to the load without battery
- Combining solar system, AC utility, and battery power source to supply continuous power
- Overload, short circuit and Deep discharge protection
- Cold start function
- Support RS485,CAN monitoring function
- Dual outputs for smart load management
- Can communicate with lithium batteries (CAN port)

Back panel description



Solar system connection

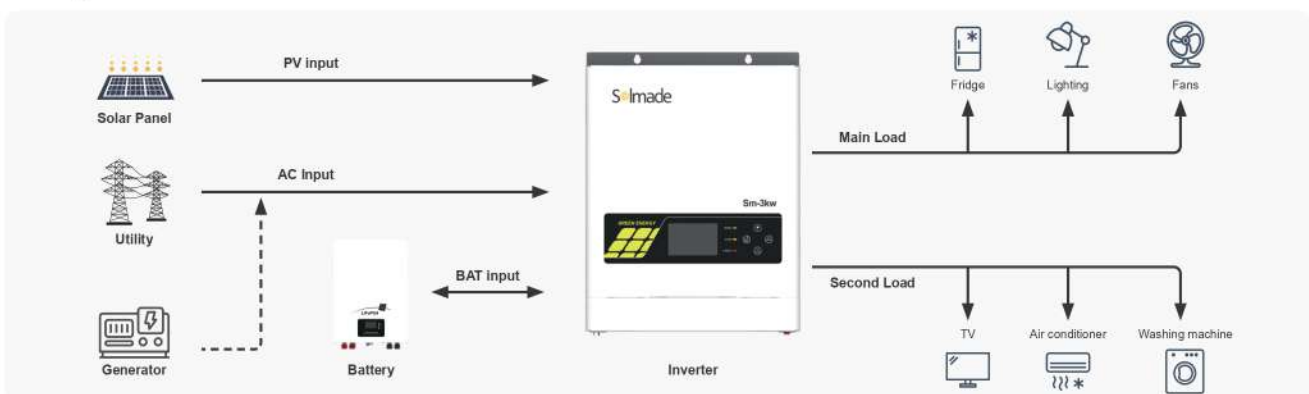

MODEL	Sm-3kw
Nominal Battery System Voltage	24VDC
INVERTER OUTPUT	
Rated Power (Main+Second Load)	3000VA/3000W
Battery Mode (Main+Second Load)	3000VA/3000W
Surge Power	6000W
Waveform	Pure sine wave
AC Voltage Regulation (Batt.Mode)	230VAC±5%(Setting)
Inverter Efficiency(Peak)	90~93%
Transfer Time	10ms (UPS / VDE4105) / 20ms (APL)
AC INPUT	
Voltage	230VAC±5%
Selectable Voltage Range	170~280VAC(UPS) / 90~280VAC(APL) / 184~253VAC(VED4105)
Frequency Range	50Hz / 60Hz(Auto sensing)
BATTERY	
Normal voltage	24VDC
Floating Charge Voltage	27.4VDC
Overcharge Protection	30VDC
SOLAR CHARGER & AC CHARGER	
Maximum PV Array Open Circuit Voltage	400VDC
Maximum PV Input Current	18A
Charging Algorithm	3-Step (Flooded Battery, AGM / GEL / LEAD Battery), 4-Step (Li)
Maximum PV Array Power	4000W
PV Array MPPT Voltage Range(Typ.)	30~320VDC
Maximum Solar Charge Current	100A
Maximum AC Charge Current	60A
Maximum Charge Current	100A
MECHANICAL SPECIFICATIONS	
Machine Dimension (W*H*D)(mm)	367.4*290*111
Package Dimension (W*H*D)(mm)	426*394*187
N.W (kg)	6.2
G.W (kg)	7.2
OTHER	
Humidity	5% to 95% Relative humidity (Non-condensing)
Operating Temperature	-10°C~50°C
Storage Temperature	-15°C~60°C
Communication Interface	USB/WIFI/RS-485/CAN
Warranty	1 year
CERTIFICATION & STANDARDS	

CE

*The technical specifications of this document are subject to change without any notice